

ER-WEN9E

19" Equipment Hinged Wall Rack Enclosure – 9U

Product Features:

Welded steel construction

Ships fully assembled

Works with all standard 19" rack equipment and accessories

Rails have numbered spaces with standard 10-32 threading

Adjustable front and rear rails

Vented top and bottom

Top and bottom cable routing knockouts

Reversible hinged tempered glass front door

Removable hinged back panel

Load capacity – 120 lbs

Black powder coat finish

Product Specifications:

(for Architects & Engineers)

The 9U (Rack Unit) wall mounted equipment rack enclosure shall be the Video Mount Products (VMP) ERWEN-9E. The overall dimensions for the ERWEN-9E are 19.9" H x 24.3" W x 21.9" D with a maximum useable depth of 16". The ERWEN-9E shall work with all EIA compliant 19" rack equipment and accessories which are less than 16" in depth. The ERWEN-9E shall come equipped with two sets of adjustable rack rails which are #10-32UNF threaded and have rack spaces numbered. The ERWEN-9E shall come with a lockable, reversible tempered glass front door. The ERWEN-9E shall have a removable wall plate with mounting holes for wooden studs with 16" centers. The ERWEN-9E shall have a lockable, hinged wall plate allowing the main enclosure to rotate 90 degrees while mounted on the wall and fully loaded. The ERWEN-9E shall have be vented top and bottom with cable entry and exit points located on the top and bottom of the wall plate and on the top of the main enclosure. The ERWEN-9E shall have two mounting points for standard fans which can be purchased separately. The ERWEN-9E shall have removable side panels which can accept locks (sold separately). The ERWEN-9E shall have a load capacity of 120 lbs. The ERWEN-9E shall be fully welded and ship assembled. The ERWEN-9E shall have a powder coat black finish.



Video Mount Products

345 Log Canoe Circle Stevensville, MD 21666

Toll Free: 877.281.2169 Telephone: 410.643.6390

Facsimile: 410.643.6615 www.videomount.com

VMP
VIDEO MOUNT PRODUCTS

ERWEN-9E

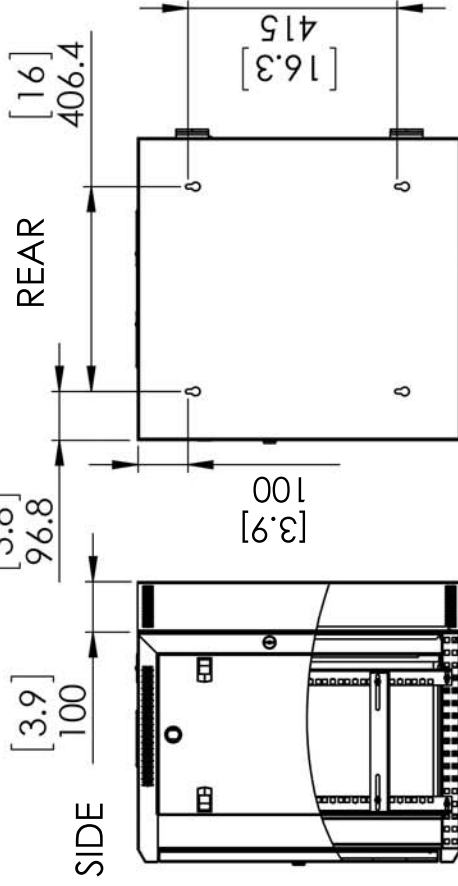
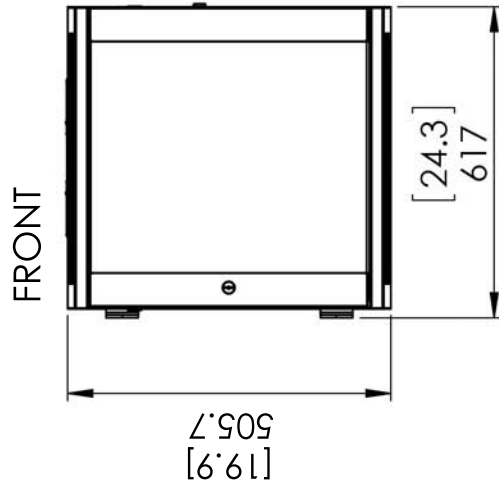
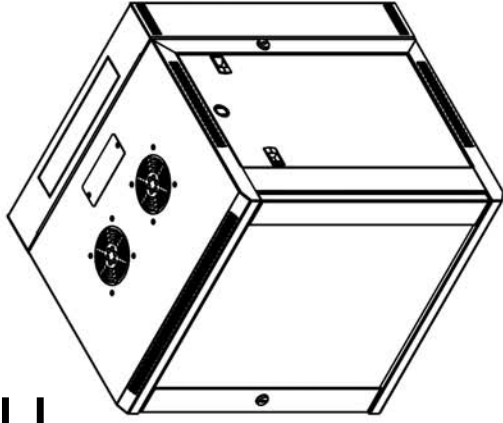
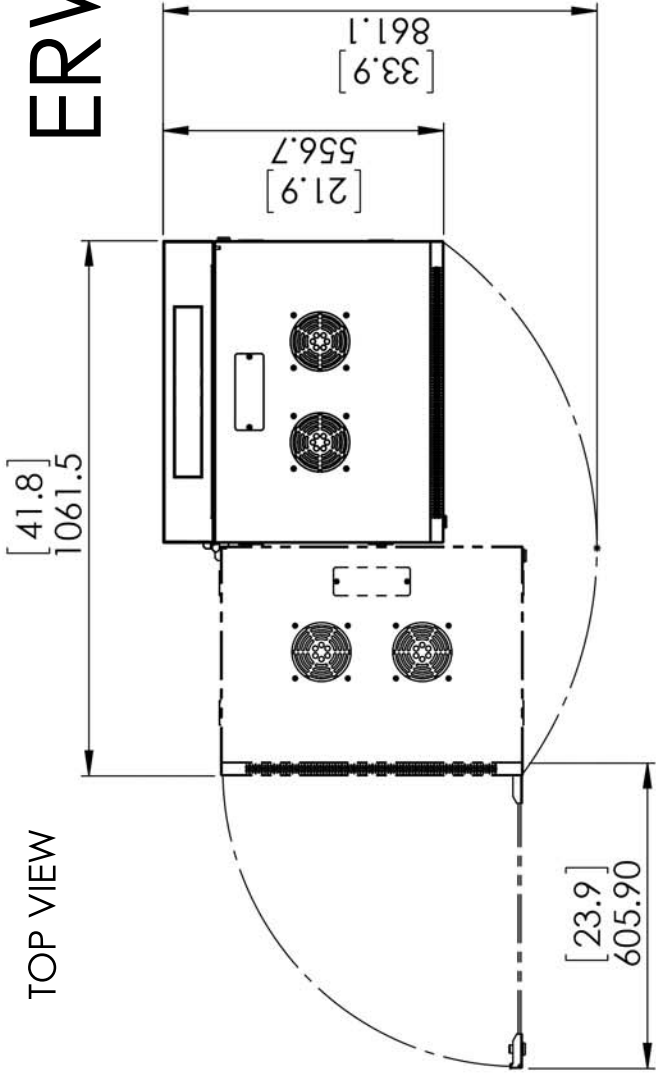

Maximum
usable depth =
406.4 [16]

Information and designs contained in this drawing are the proprietary property of Video Mount Products (VMP). None of the design or any information contained in this drawing may be reproduced or disclosed to others without prior written consent of Video Mount Products (VMP).



Units: mm [inch]