

THIS COPY IS PROVIDED ON A RESTRICTED BASIS AND IS NOT TO BE USED IN ANY WAY DETRIMENTAL TO THE INTERESTS OF PANDUIT CORP.

PANDUIT P/N	WEIGHT
WB89D	1.6 LB/10 PCS (725g/10 PCS)

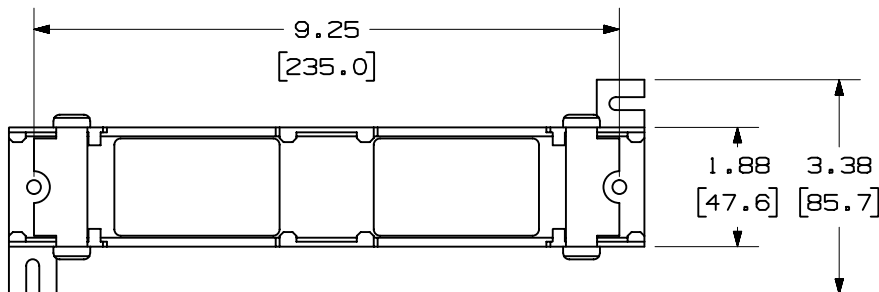

NOTES:

1. SEE CURRENT CATALOG FOR ADDITIONAL PART NUMBER SUFFIXES TO INDICATE COLOR AND OR PACKAGE QUANTITY.
2. SEE CATALOG FOR COMPLETE LIST OF PARTS APPLICABLE FOR USE WITH THIS PART.
3. DIMENSIONS IN PARENTHESES ARE IN METRIC.

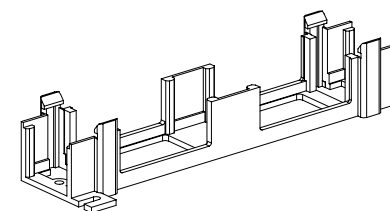
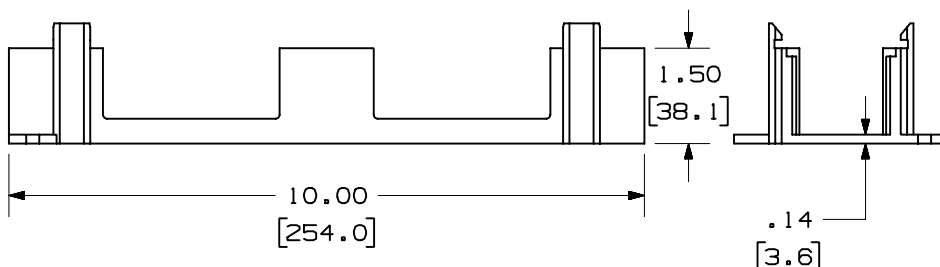

MODEL FILENAME	D35543BD_89D_01.PRT	SIZE	A
DRAWING FILENAME	D35543BD_DC_01A.PRT		

89D MOUNTING BRACKET
CUSTOMER DRAWING

PANDUIT ™ CORP. TINLEY PARK, ILL 60477	I.I. NUMBER	N/A
	PRODUCT SPEC	N/A
THIRD ANGLE PROJECTION ALL DIMENSIONS ARE GIVEN IN INCHES, UNLESS OTHERWISE SPECIFIED. DIMENSIONAL TOLERANCES ARE: (.X) ± (.XXX) ± .010(.31) (.XX) ± .03(.8) ANGLES ±	WORK INSTRUCTION	N/A
	SCALE	NONE
DRAWN BY DW	MATERIAL:	PART NO. WB89D
DATE 3-19-96	THERMOPLASTIC	DRAWING NO. 35543-04
CHK'D CEF		

REV	DATE	BY	CHK	DESCRIPTION	ECN	R	CUST	SUP	OTH
2	12-25-02	JSP		B. REVISED DESIGN OF PART.	35543-04				
1	11-12-99	JSP	CEF	A. REVISED NOTE 2.	35543-04				
R	4-02-96	DW	CEF	RELEASED TO PRODUCTION	35543-04				