

lev-lok™

Modular Receptacles

A new line of wiring devices engineered for fast & easy installation





Lock and Latch Wiring Module Simplifies Large Wiring Device Jobs While Delivering the Most Secure Connection

Leviton's latest receptacle family is a revolutionary design called the Lev-Lok™ Modular Receptacle System. It consists of a wiring module (locking connector and leads) and a rugged duplex receptacle with solid brass locking connection pins. Place the wiring module over the receptacle's locking pins, twist clockwise and the connection is secured. Leviton's modular devices address the reliability and performance concerns of specification engineers without sacrificing the contractor's need for fast, easy installation. They are ideal for both retrofit and new construction in universities, hospitals, hotels and office complexes.

Modular Design Streamlines Installation and Reduces Costs

Simple...

Designed with the busy contractor in mind.

All of Leviton's Lev-Lok wiring modules arrive equipped with protective cover and circuit ID label. The unique protective cover keeps the module's connections debris-free until the receptacles are installed. The wiring module's circuit ID label eliminates a post rough-in step and makes troubleshooting faster and easier.

Lev-Lok's innovative lock and latch design eliminates guesswork by allowing only one module orientation. The wire leads always mate to the same receptacle terminals during installation or replacement making installation simple, fast, and accurate.



MSTWL with circuit ID label.

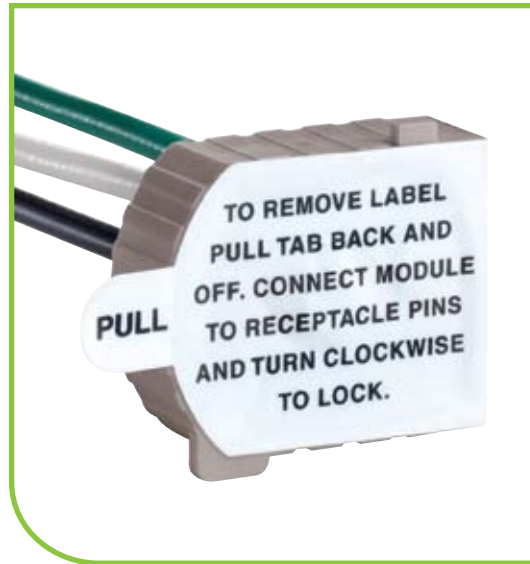

MSTWL wiring module with protective cover.

Easy...

Connect and twist to lock.

In just two quick and easy steps, the receptacle is securely attached to the wiring module. Simply place the wiring module over the receptacle's connection pins and twist clockwise to lock.

Replacing a receptacle? It's just as easy. Reverse the same two steps... turn module counter clockwise to unlock and remove.



Lock and latch. It's that easy.

Secure...

Lock & latch system.

Leviton's connection system locks and latches the wiring module to the receptacle providing double the security without adding to the assembly steps.

Designed for high usage areas such as hospitals and schools, Lev-Lok receptacle replacement is easy and secure.

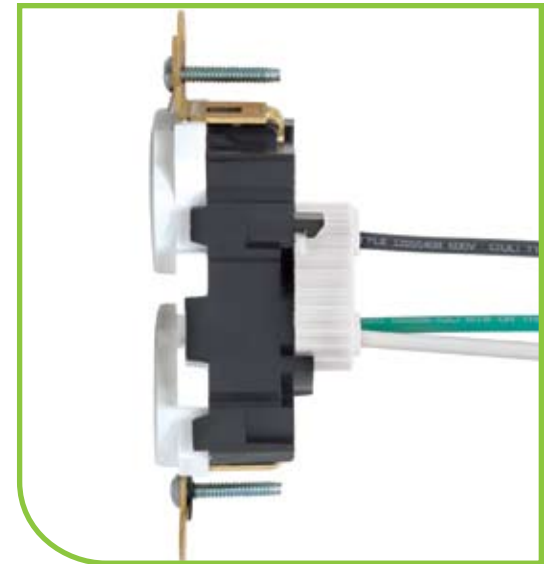

Engineered for safety and longevity.

Smooth face prevents dirt from collecting and makes cleaning faster and simpler

Grounding clip permanently secured to strap makes for most reliable equipment ground connection

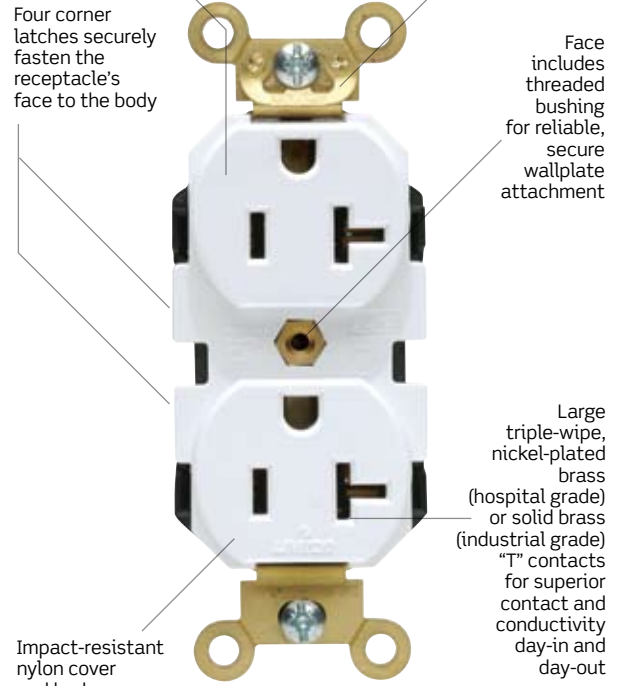

M5362-W Duplex Receptacle

Four corner latches securely fasten the receptacle's face to the body

Face includes threaded bushing for reliable, secure wallplate attachment

Large triple-wipe, nickel-plated brass (hospital grade) or solid brass (industrial grade) "T" contacts for superior contact and conductivity day-in and day-out

Impact-resistant nylon cover and body

Nickel-plated brass (hospital grade) or solid brass (industrial grade) single-piece, wrap-around mounting strap with integral ground contact, for continuous conductivity and secure ground path

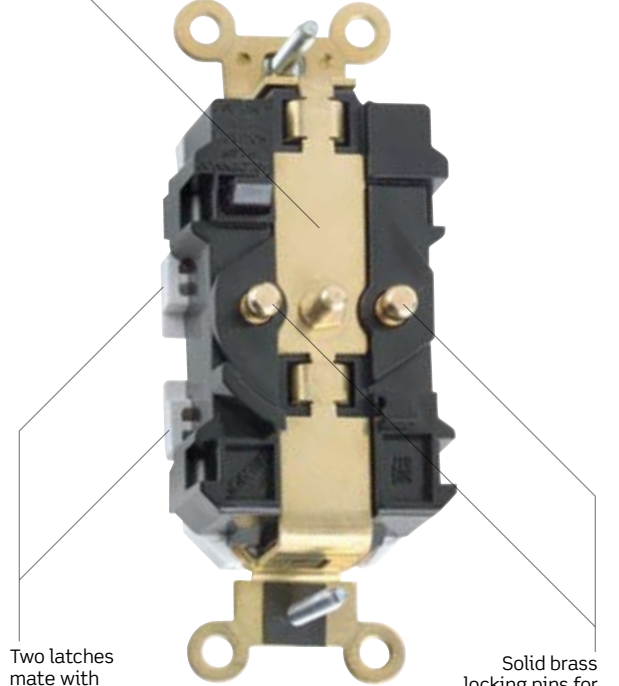

Two latches mate with wiring module for twice the security

Solid brass locking pins for strong, secure connection between receptacle and wiring module

Impact resistant nylon cover withstands abuse

Look for the Lock! Patented Lockout feature prevents RESET if the GFCI circuit is no longer functioning properly.

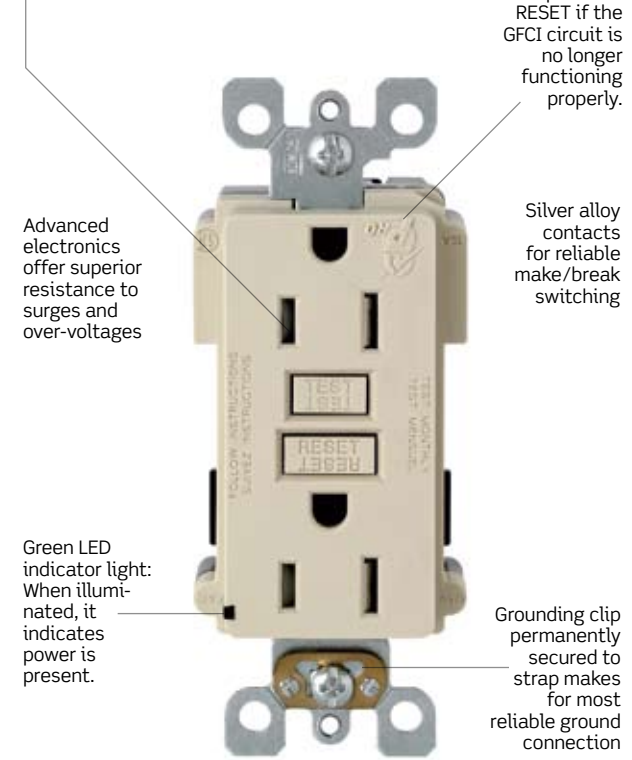

M7599-I GFCI Receptacle

Advanced electronics offer superior resistance to surges and over-voltages

Silver alloy contacts for reliable make/break switching

Green LED indicator light: When illuminated, it indicates power is present.

Grounding clip permanently secured to strap makes for most reliable ground connection

Two latches mate with wiring module for twice the security

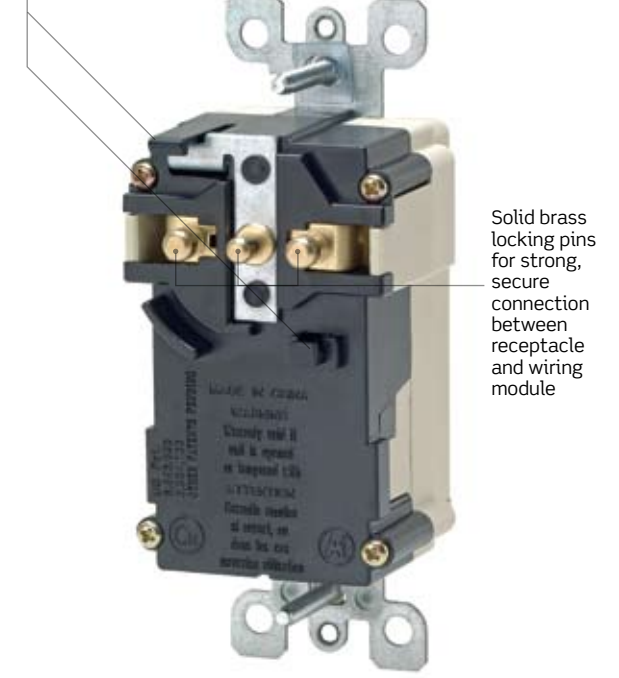

Solid brass locking pins for strong, secure connection between receptacle and wiring module

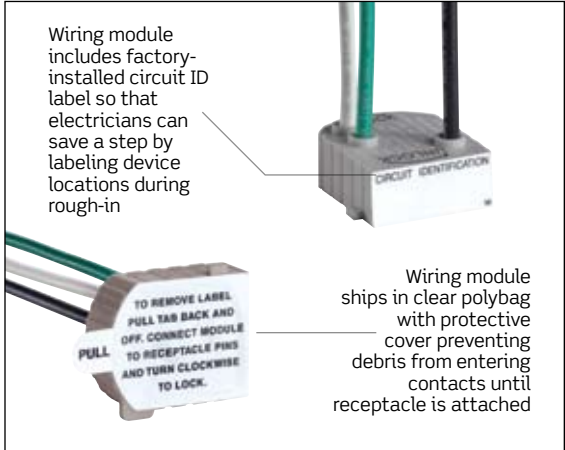

Wiring module includes factory-installed circuit ID label so that electricians can save a step by labeling device locations during rough-in

Wiring module ships in clear polybag with protective cover preventing debris from entering contacts until receptacle is attached

TO REMOVE LABEL PULL TAB BACK AND OFF. CONNECT MODULE TO RECEPTACLE PINS AND TURN CLOCKWISE TO LOCK.



MSTWL Wiring Module

Wiring module locks and latches to the receptacle body providing double the connection security

Wiring module indicates the direction of orientation to Lock and Latch!

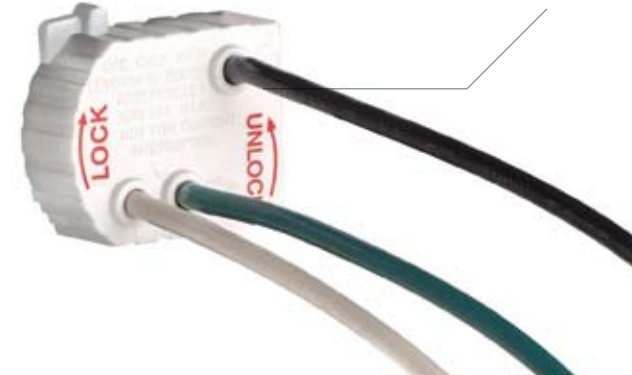

Complementary wallplates made from plastic, nylon, or metal are available for Lev-Lok receptacles. Choose from:

- Single, Two, Three, & Four Gang
- Eight Colors: Ivory, Black, Gray, Blue, White, Brown, Red, Light Almond, & Stainless Steel
- Hot Stamped or Engraved

Duplex Receptacles

Industrial Grade

Comply with cULus, Fed. Spec., ANCE, NOM 057

Color	15A-125V	20A-125V
Brown	M5262	M5362
Ivory	M5262-I	M5362-I
White	M5262-W	M5362-W
Black	M5262-E	M5362-E
Blue	M5262-B	M5362-B
Gray	M5262-GY	M5362-GY
Red	M5262-R	M5362-R
Light Almond	M5262-T	M5362-T

Hospital Grade

Comply with cULus, Fed. Spec., Hospital Grade, ANCE, NOM 057

Color	15A-125V	20A-125V
Brown	M8200	M8300
Ivory	M8200-I	M8300-I
White	M8200-W	M8300-W
Black	M8200-E	M8300-E
Blue	M8200-B	M8300-B
Gray	M8200-GY	M8300-GY
Red	M8200-R	M8300-R
Light Almond	M8200-T	M8300-T

SmartLockPRO GFCI Receptacles

Commercial Grade

Comply with cULus, ANCE, NOM 057

Color	15A-125V	20A-125V
Brown	M7599	M7899
Ivory	M7599-I	M7899-I
White	M7599-W	M7899-W
Gray	M7599-GY	M7899-GY
Red	M7599-R	M7899-R
Light Almond	M7599-T	M7899-T

Hospital Grade

Comply with cULus, Hospital Grade, ANCE, NOM 057

Color	15A-125V	20A-125V
Ivory	M7599-HGI	M7899-HGI
White	M7599-HGW	M7899-HGW
Gray	M7599-HGY	M7899-HGY
Red	M7599-HGR	M7899-HGR
Light Almond	M7599-HGT	M7899-HGT



Wiring Module

Color	20A Max.
White	MSTWL

**10 YEAR LIMITED
WARRANTY**