

KENDALL HOWARD ®

Assembly Instructions

Wedge Anchor Kit— $3/8''$ x $3''$

SKU: 0300-1-004-00

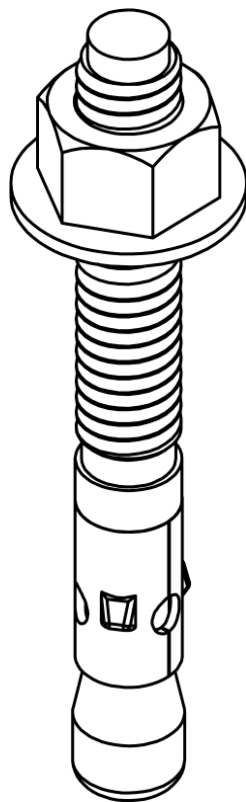

Tools Needed:

Safety Glasses

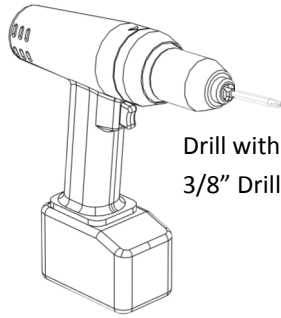
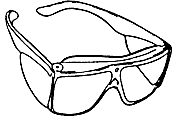

Drill with 3/8" Drill Bit

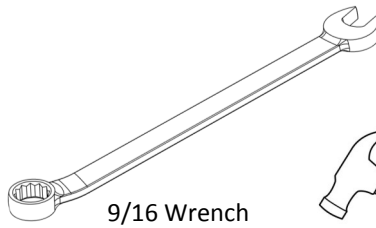

9/16 Wrench

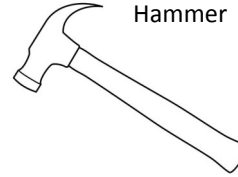

Hammer



Compressed Air

Step 1:

Use 3/8" drill bit to make a minimum 1 1/2" hole in concrete floor or wall.

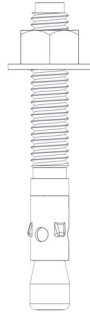

Step 2:

Remove debris from the hole.

Step 3:

Hammer in wedge anchor.

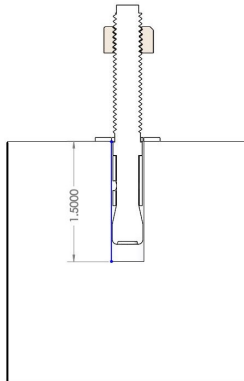

Step 4:

Tighten nut using box wrench.

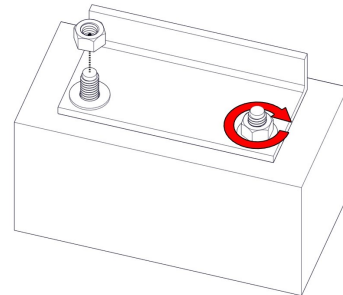

DISCLAIMER: Kendall Howard LLC. endeavors to make this manual accurate and complete. However, Kendall Howard LLC makes no representations or warranties of any kind, expressed or implied, about whether the use of products contained herein would infringe any rights or the correctness, accuracy or reliability of the information contained herein or that said information covers all details, conditions or variations. The information herein does not provide for every possible contingency in connection with the installation or use of the product(s). The information contained in this document is subject to change without notice or obligation. Kendall Howard LLC assumes no responsibility for the accuracy, completeness or reliability of the information contained in this document. Any reliance placed on the information is therefore strictly at your own risk.